

STAGE 6

Hollywood Center Studios

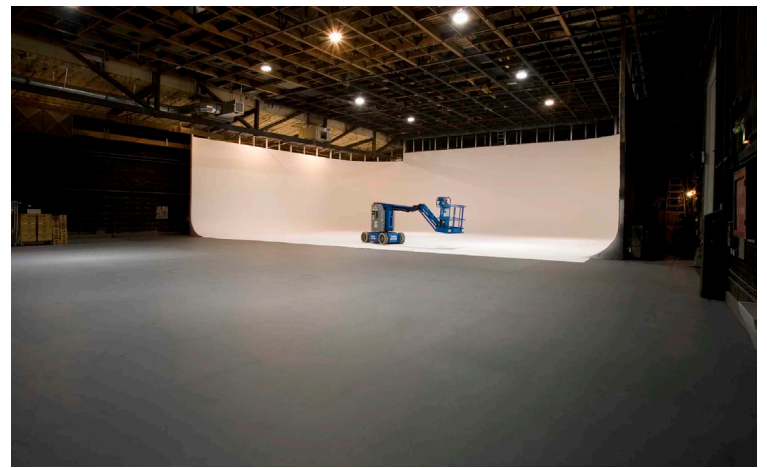
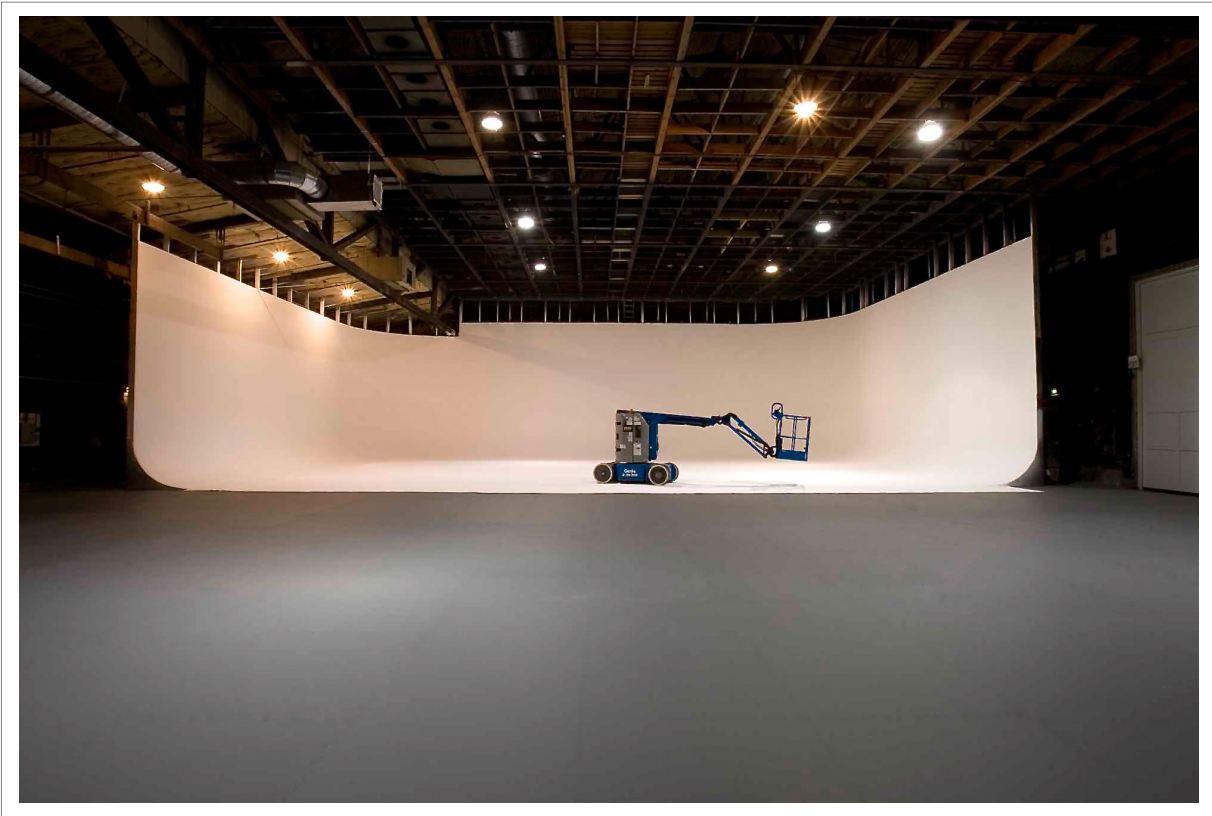

Hollywood Center Studios
1040 N. Las Palmas Ave.
Hollywood, CA
[T] (323) 860-0000
[F] (323) 860-8105
stages@HollywoodCenter.com
www.HollywoodCenter.com

LENGTH: 119'
WIDTH: 90'
HEIGHT: Main = 26'6"; low = 20'
DOOR SIZE: Ht. 18' Wd. 13'6"
AREA SQUARE-FEET: 10,710
CYC: 54'L x 76'W x 59'H
A/C: 80 tons*, Silent
AC POWER: 3000 amps*
DC POWER: 2000 amps

* additional power or air may be available

** additional bandwidth up to 20 megabits available immediately

DRIVE-IN: Yes
AUDIENCE-RATED: No
CAT WALKS: Yes
HARD-COVERED CYC: Three-wall
FLOORS: Wood over slab small pit
VIDEO CONTROL ROOM CONNECTIVITY: No
WIFI/INTERNET: complementary 256kb internet service (if kb=kilobits) with daily packages for commercial productions.**
FOR SYNC SOUND: Yes

STAGE 6

Hollywood Center Studios

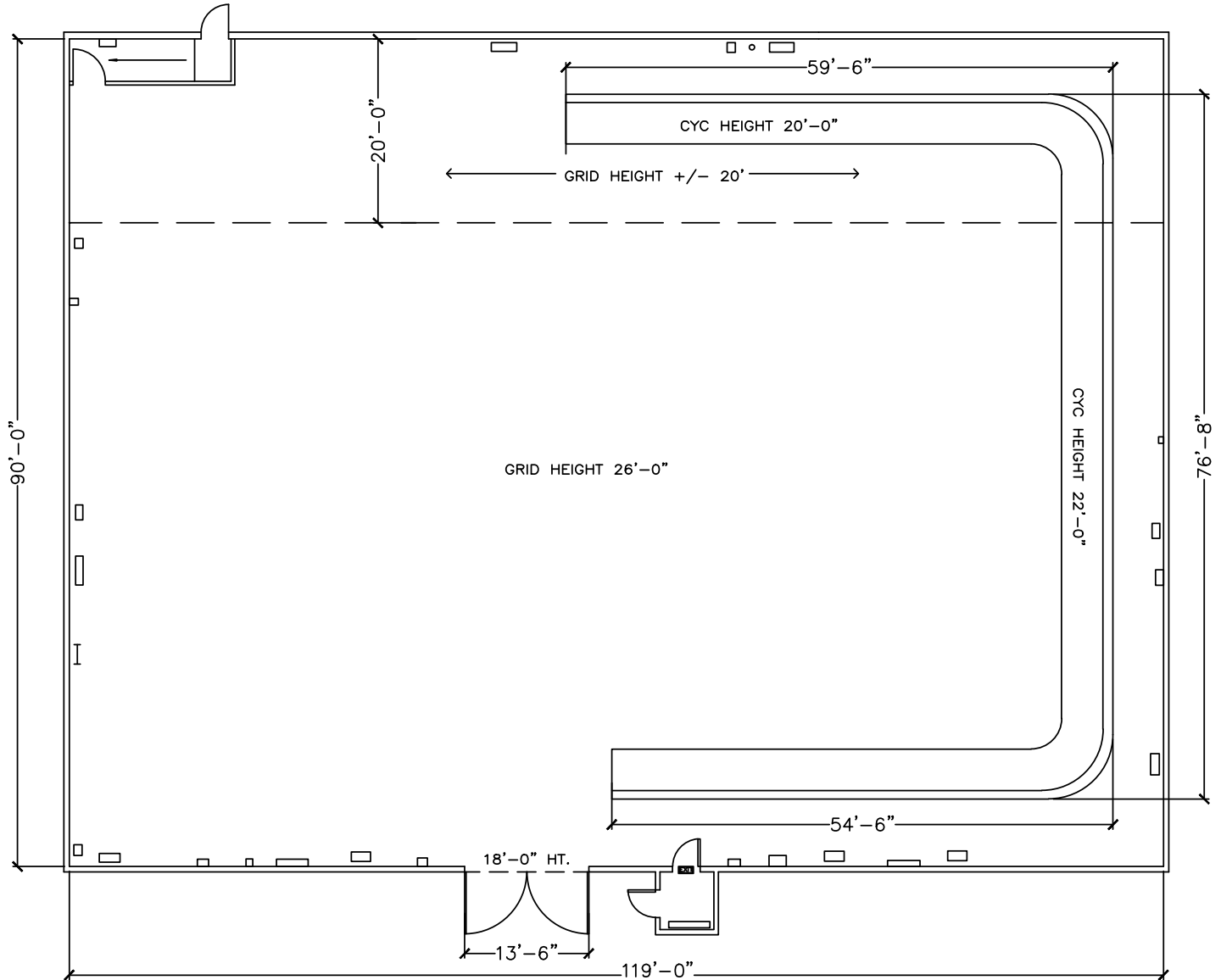

LENGTH: 119'

WIDTH: 90'

HEIGHT: Main = 26'6"; low = 20'

DOOR SIZE: Ht. 18' Wd. 13'6"

AREA SQUARE-FEET: 10,710

CYC: 54'L x 76'W x 59'H

A/C: 80 tons*, Silent

AC POWER: 3000 amps*

DC POWER: 2000 amps

DRIVE-IN: Yes

AUDIENCE-RATED: No

CAT WALKS: Yes

HARD-COVERED CYC: Three-wall

FLOORS: Wood over slab small pit

VIDEO CONTROL ROOM CONNECTIVITY: No

WIFI/INTERNET: complementary 256kb internet service (if kb=kilobits) with daily packages for commercial productions.**

FOR SYNC SOUND: Yes

* additional power or air may be available

** additional bandwidth up to 20 megabits available immediately

Hollywood Center Studios
1040 N. Las Palmas Ave.
Hollywood, CA
[T] (323) 860-0000
[F] (323) 860-8105
stages@HollywoodCenter.com
www.HollywoodCenter.com

Note: Dimensions are for overall stage size and do not take into account stage irregularities. Production Company representatives should verify dimensions for particular applications.

STAGE 6

Hollywood Center Studios

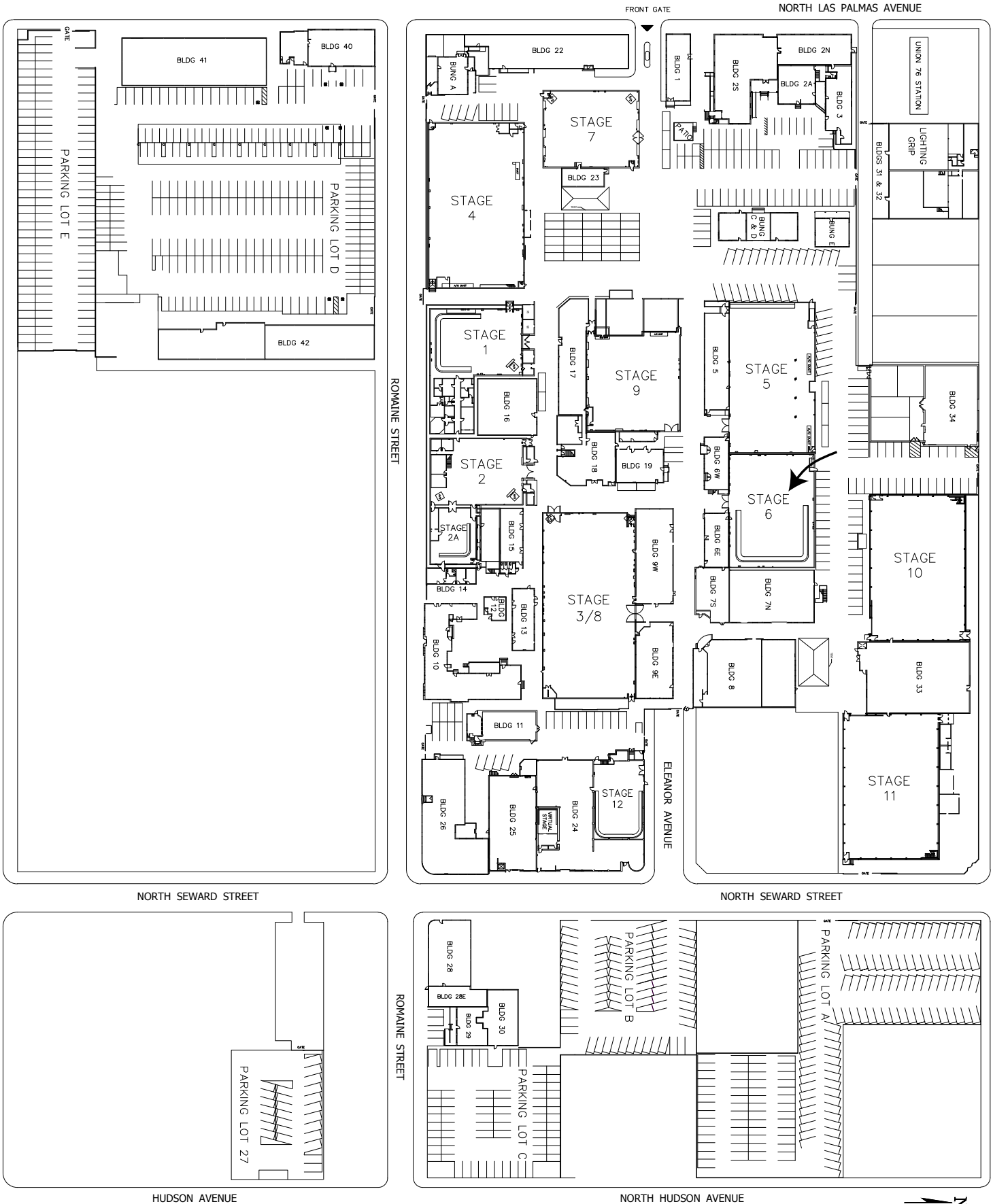

NORTH SEWARD STREET

NORTH SEWARD STREET

HUDSON AVENUE

NORTH HUDSON AVENUE