

# STAGE 5

# Hollywood Center Studios



Hollywood Center Studios  
1040 N. Las Palmas Ave.  
Hollywood, CA  
[T] (323) 860-0000  
[F] (323) 860-8105  
Stages@HollywoodCenter.com  
www.HollywoodCenter.com

**LENGTH:** 158'  
**WIDTH:** 90'  
**HEIGHT:** Main = 25'; low = 20'  
**DOOR SIZE:** Ht. 18' Wd. 14"  
**AREA SQUARE-FEET:** 14,220  
**CYC:** WHITE; 70' Single Wall  
**A/C:** Red-lighted system  
**AC POWER:** 3600 amps\*  
**DC POWER:** 2000 amps

**AUDIENCE-RATED:** Yes  
**DRIVE-IN:** Limited weight  
**CAT WALKS:** Yes  
**FLOORS:** Raised wood  
**VIDEO CONTROL ROOM CONNECTIVITY:** Yes  
**WIFI/INTERNET:** complementary 256kb internet service (if kb=kilobits) with daily packages for commercial productions.\*\*  
**FOR SYNC SOUND:** Yes

\* additional power or air may be available

\*\* additional bandwidth up to 20 megabits available immediately

# STAGE 5

# Hollywood Center Studios

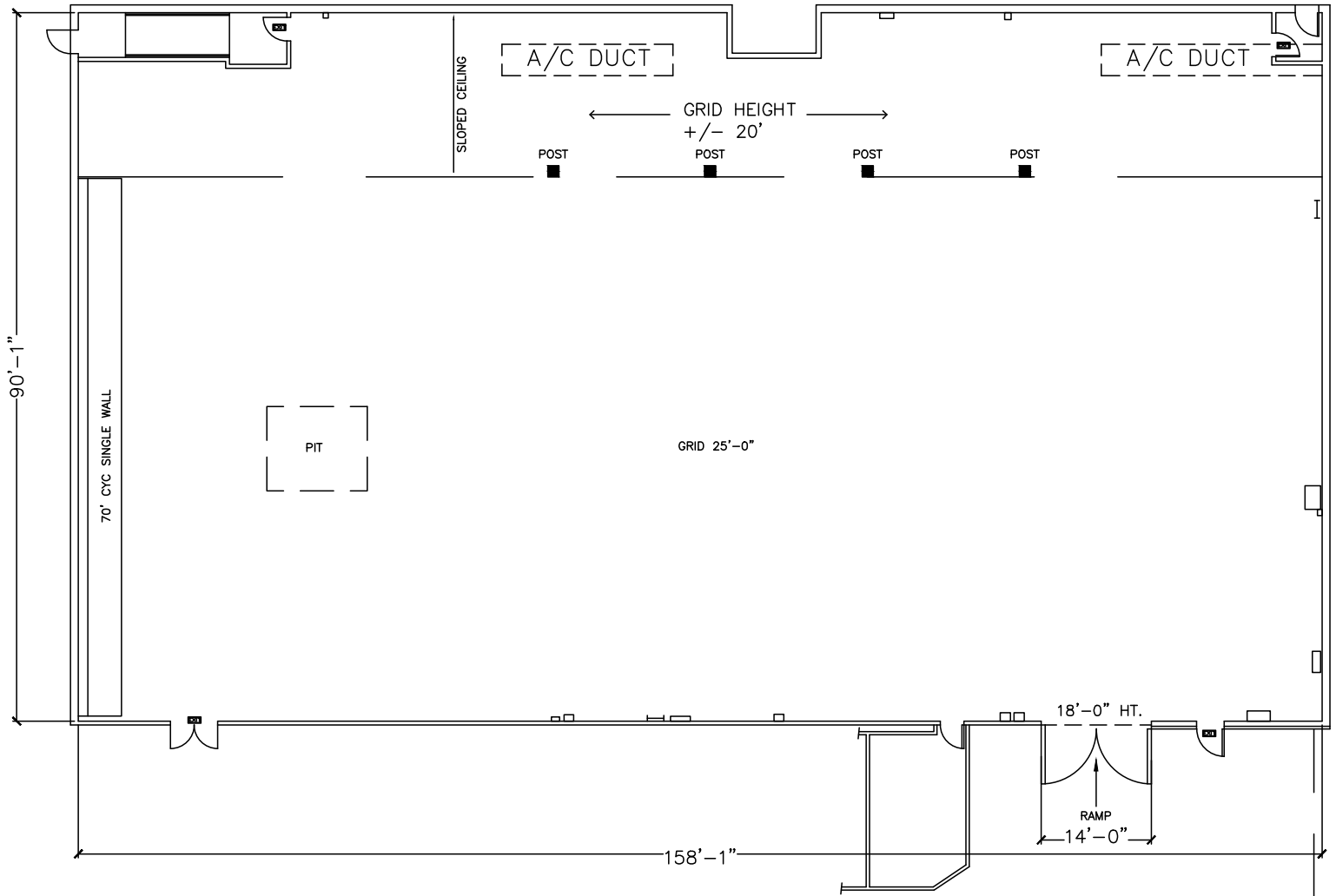

**LENGTH:** 158'

**WIDTH:** 90'

**HEIGHT:** Main = 25'; low = 20'

**DOOR SIZE:** Ht. 18' Wd. 14"

**AREA SQUARE-FEET:** 14,220

**CYC:** WHITE; 70' Single Wall

**A/C:** Red-lighted system

**AC POWER:** 3600 amps\*

**DC POWER:** 2000 amps

**AUDIENCE-RATED:** Yes

**DRIVE-IN:** Limited weight

**CAT WALKS:** Yes

**FLOORS:** Raised wood

**VIDEO CONTROL ROOM CONNECTIVITY:** Yes

**WIFI/INTERNET:** complementary 256kb internet service (if kb=kilobits) with daily packages for commercial productions.\*\*

**FOR SYNC SOUND:** Yes

\* additional power or air may be available

\*\* additional bandwidth up to 20 megabits available immediately

Note: Dimensions are for overall stage size and do not take into account stage irregularities. Production Company representatives should verify dimensions for particular applications.

Hollywood Center Studios  
1040 N. Las Palmas Ave.  
Hollywood, CA  
[T] (323) 860-0000  
[F] (323) 860-8105  
Stages@HollywoodCenter.com  
www.HollywoodCenter.com

# STAGE 5

# Hollywood Center Studios

