

# STAGE 4

# Hollywood Center Studios



Hollywood Center Studios  
1040 N. Las Palmas Ave.  
Hollywood, CA  
[T] (323) 860-0000  
[F] (323) 860-8105  
stages@HollywoodCenter.com  
www.HollywoodCenter.com

**LENGTH:** 174'

**WIDTH:** 101'

**HEIGHT:** 35'

**DOOR SIZE:** Ht. 20' Wd. 15'3"

**AREA SQUARE-FEET:** 17,574

**A/C:** 160 tons, Silent

**AC POWER:** 5000 amps\*

**DC POWER:** 3000 amps

**DRIVE-IN:** Yes

**AUDIENCE-RATED:** 250 + crew of 49: A2 rating

**CAT WALKS:** Yes

**FLOORS:** Raised wood

**WIFI/INTERNET:** complementary 256kb internet service (if kb=kilobits) with daily packages for commercial productions.\*\*

**VIDEO CONTROL ROOM CONNECTIVITY:** Yes; triax & audio break outs/ tech power

**FOR SYNC SOUND:** Yes

\* additional power or air may be available

\*\* additional bandwidth up to 20 megabits available immediately

# STAGE 4

# Hollywood Center Studios

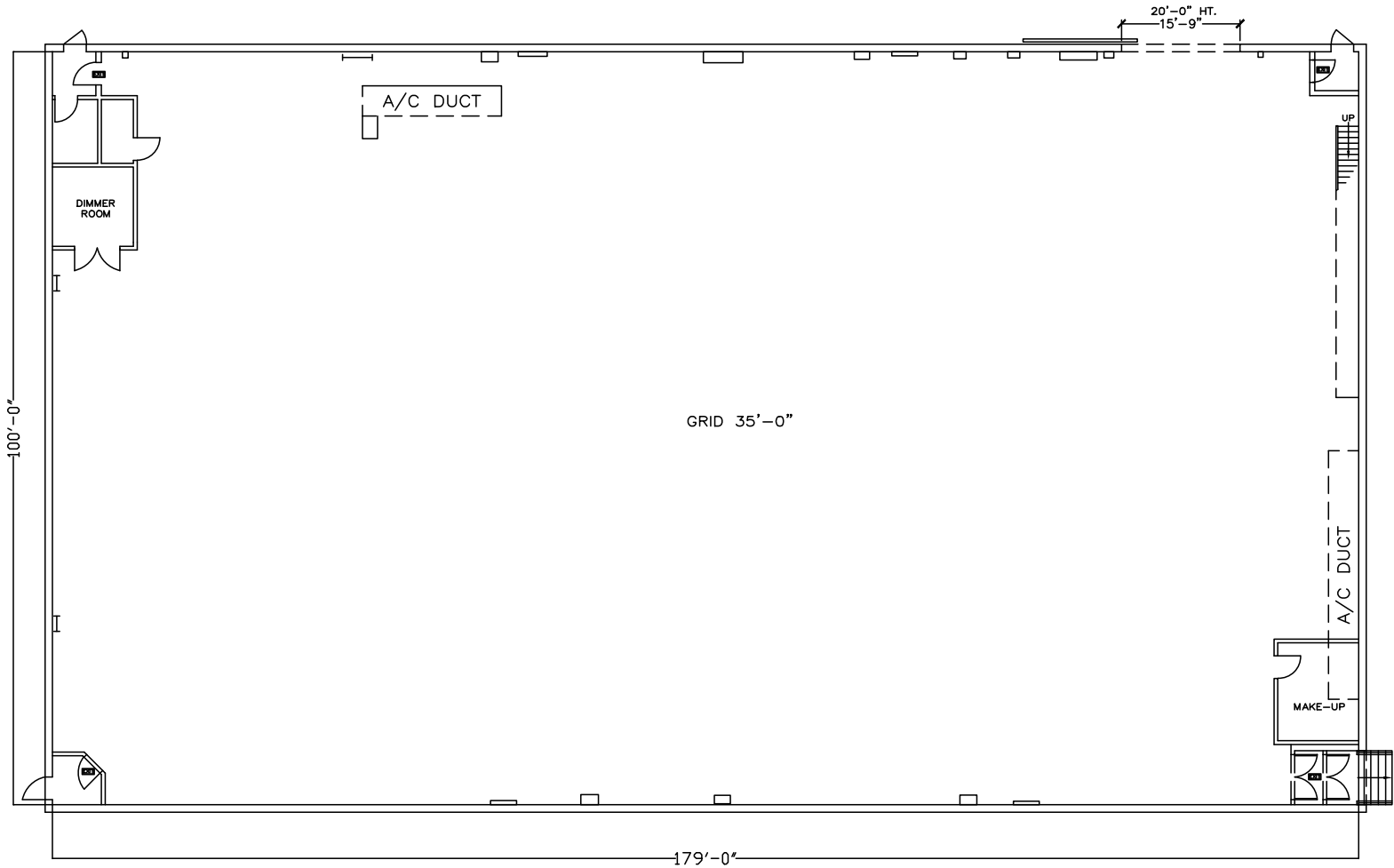

**LENGTH:** 174'

**WIDTH:** 101'

**HEIGHT:** 35'

**DOOR SIZE:** Ht. 20' Wd. 15'3"

**AREA SQUARE-FEET:** 17,574

**A/C:** 160 tons, Silent

**AC POWER:** 5000 amps\*

**DC POWER:** 3000 amps

**DRIVE-IN:** Yes

**AUDIENCE-RATED:** 250 + crew of 49: A2 rating

**CAT WALKS:** Yes

**FLOORS:** Raised wood

**WIFI/INTERNET:** complementary 256kb internet service (if kb=kilobits) with daily packages for commercial productions.\*\*

**VIDEO CONTROL ROOM CONNECTIVITY:** Yes; triax & audio break outs/ tech power

**FOR SYNC SOUND:** Yes

\* additional power or air may be available

\*\* additional bandwidth up to 20 megabits available immediately

Hollywood Center Studios  
1040 N. Las Palmas Ave.  
Hollywood, CA  
[T] (323) 860-0000  
[F] (323) 860-8105  
stages@HollywoodCenter.com  
www.HollywoodCenter.com

Note: Dimensions are for overall stage size and do not take into account stage irregularities. Production Company representatives should verify dimensions for particular applications.

# STAGE 4

# Hollywood Center Studios

